

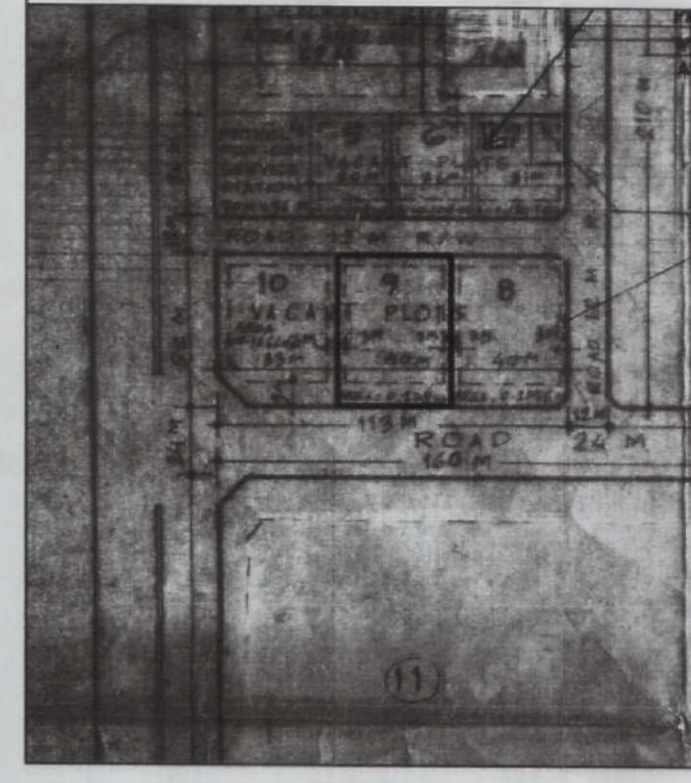

**DELHI DEVELOPMENT AUTHORITY**

Details regarding plot size, development control norms, set backs:-

Plot No.	Area (sq.m)	Proposed to be Sub-divided	Area in sq.m
9	2080	(i) 9-A (ii) 9-B (iii) 9-C	500 (20 X 25 m) 500 (20 X 25 m) 1080 (27 X 40 m)



Sl. No	Set backs				Development Control norms
	Front (m)	Rear (m)	Side (m)	Side (m)	
(i)	4	3	3	-	For plot no. 9-A & 9-B i.e. 500 sq.m. as per MPD 2021 norms for smaller plots.
(ii)	4	3	3	-	
(iii)	6	3	3	3	For plot no. 9-C As per MPD-2021 norms.

- NOTES:-**
- DO NOT SCALE THE DRAWING. WRITTEN DIMENSIONS TO BE FOLLOWED.
  - IN CASE OF ANY DISCREPANCY THE SAME BE BROUGHT TO THE NOTICE OF DIR. (PLG) NARELA.
  - NECESSARY PERMISSION SHALL BE TAKEN FROM THE CONCERNED DEPARTMENT FOR CUTTING OF TREES.
  - MASTER PLAN FILE NO. FOR SECTOR A-7 NARELA IS F3(34)2010/MP.
- NOTE:-**  
APPROVED BY 303rd SCREENING COMMITTEE HELD ON 21.12.2011 VIDE ITEM NO. 113:2011 IN FILE NO. F3(34)2010/MP

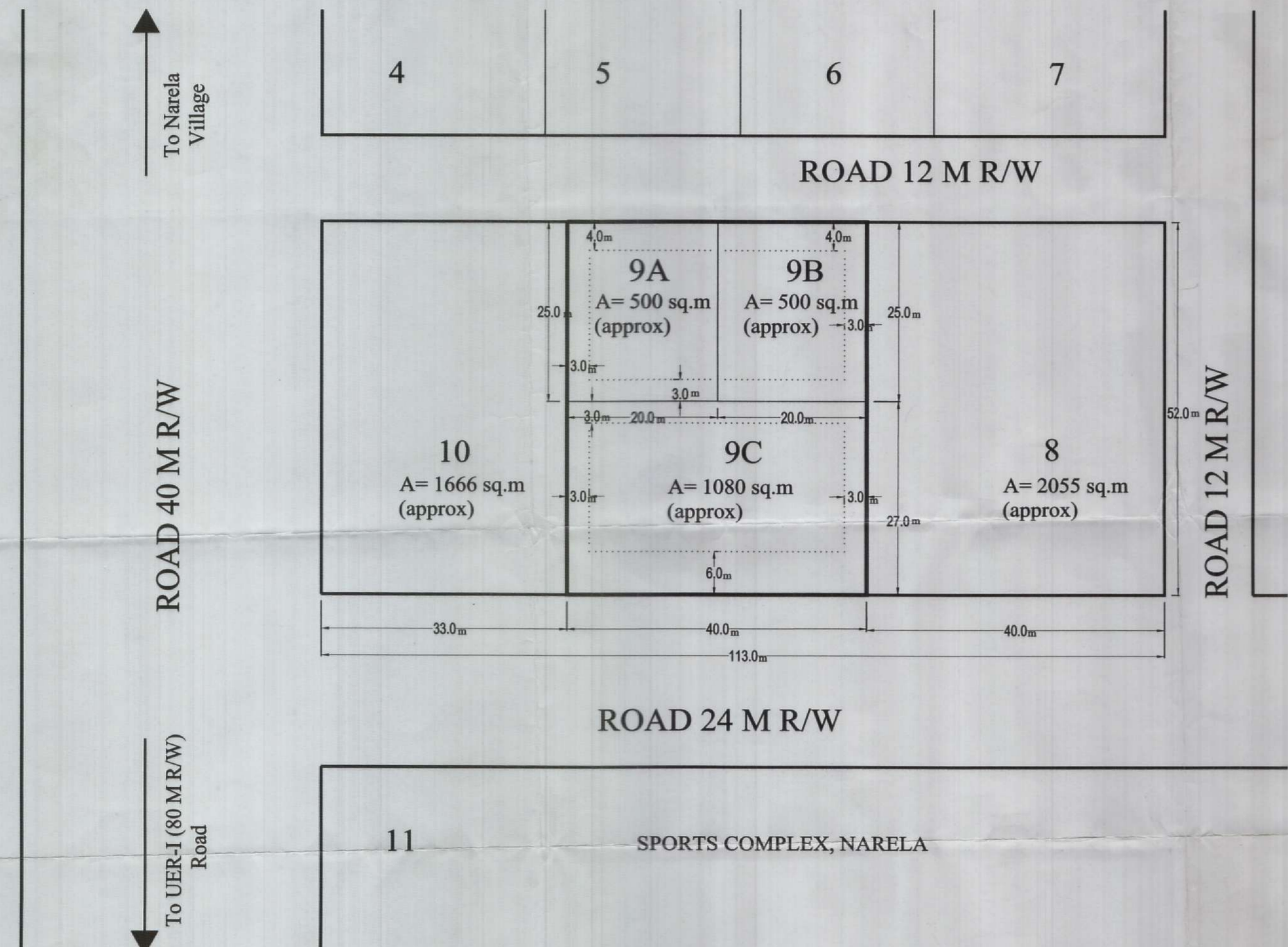

DELHI DEVELOPMENT AUTHORITY  
Approved in 303rd Screening Committee Meeting Held on 21.12.2011 Item No. 113:2011  
Director (Plg.)

DELHI DEVELOPMENT AUTHORITY  
HUPV, NARELA  
This project was approved by the 303rd Screening Committee Meeting held on 21.12.2011 vide Item No. 113:2011  
Director (Arch.) Coord.

**PART PLAN OF LOP, SECTOR A-7, NARELA**

**SUB-DIVISION OF PLOT NO. 9, PUBLIC & SEMI PUBLIC FACILITY AREA, SECTOR A-7 (FA-2), NARELA**

SCALE 1:500  
DRAWING NO.

PLG. ASST.	ASST. DIR.	JOINT. DIR. (PLG)
DIRECTOR (PLG)	ADDL. COMM. (PLG.)	COMMISSIONER (PLG.)

**NARELA PROJECT**

To Narela Village  
ROAD 40 M R/W  
ROAD 12 M R/W  
ROAD 24 M R/W  
To UER-I (80 M R/W) Road

